

WWD30



FEATURES

- _____ Distributes heat evenly from 80 to 200 degrees Fahrenheit using fans
- _____ Includes food presets, such as bread, cooked cereals, and pizza
- _____ Tested and approved for warming towels
- _____ Fits entrées and sides easily in its generous 30 inch drawer cavity
- _____ Includes hidden electronic controls
- _____ Offers automatic shut-off

ACCESSORIES

- _____ 30" Stainless Professional Front Panel - 2" Thick
- _____ 36" Stainless Professional Front Panel - 2" Thick
- _____ 6-Piece Container Set
- _____ Contemporary Handle- E Series
- _____ Contemporary/Transitional Handle
- _____ Professional Handle-E Series
- _____ Professional Handle-M Series
- _____ Transitional Handle- M Series
- _____ Warming Drawer Front Panel - Integrated
- _____ Warming Drawer Front Panels - M Series
- _____ Warming Drawer Front Panels - E Series

Accessories available through an authorized dealer.
 For local dealer information, visit subzero-wolf.com/locator.



FRONT PANEL OPTIONS



30" E SERIES TRANSITIONAL



30" E SERIES PROFESSIONAL



30" E SERIES CONTEMPORARY



30" M SERIES CONTEMPORARY



30" M SERIES TRANSITIONAL



30" M SERIES CONTEMPORARY STAINLESS



30" M SERIES PROFESSIONAL



30" L SERIES



30" INTEGRATED

PRODUCT SPECIFICATIONS

Model	WWD30
Dimensions	29 7/8"W x 10 3/8"H x 22 3/4"D
Capacity	1.6 cu. ft.
Weight	75 lbs
Electrical Supply	120 VAC, 60 Hz
Electrical Service	15 amp dedicated circuit
Power Cord Length	3 Feet
Receptacle	3-prong grounding-type

ELECTRICAL

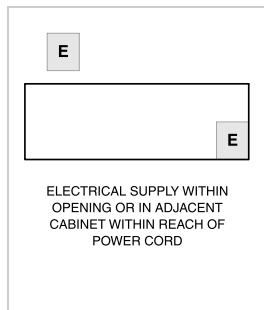

INSTALLATION WITH FRONT PANEL Accessory front panels may affect overall product dimensions and opening dimensions. Refer to Reveal for more information: subzero-wolf.com/reveal

NOTE: Dimensions in parenthesis are in millimeters unless otherwise specified

DIMENSIONS

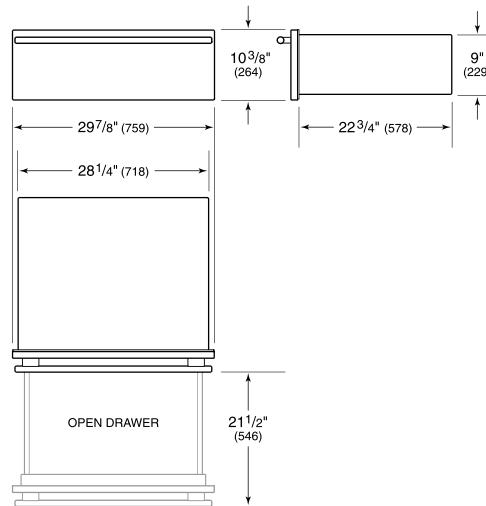

STANDARD INSTALLATION

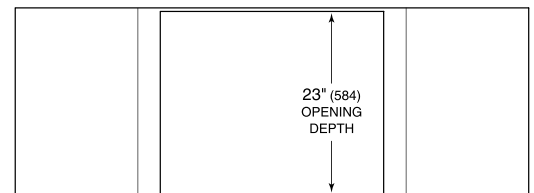

TOP VIEW

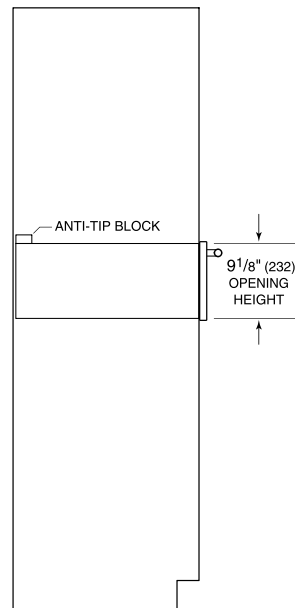

SIDE VIEW

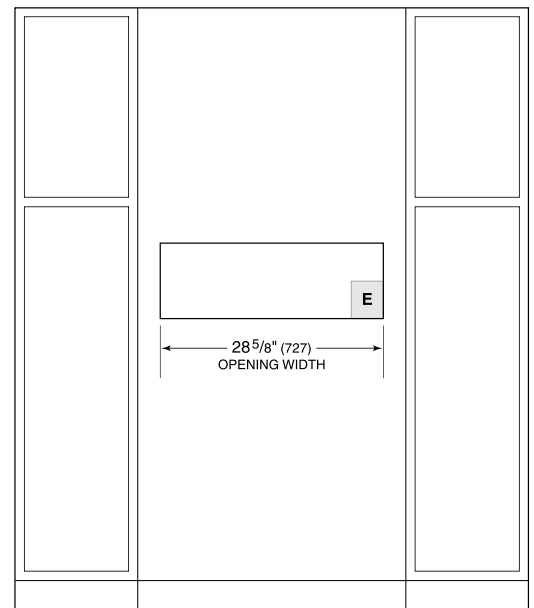

FRONT VIEW

NOTE: Location of electrical supply within opening may require additional cabinet depth.